



Sarva Vidyalaya Kelavani Mandal managed

UMA ARTS AND NATHIBA COMMERCE MAHILA COLLEGE

Sarva Vidyalaya Campus, Sector - 23, Gandhinagar – 382023

(Estd. in 1991, Affiliated with Gujarat University-College Code 191 – AISHE Code C-5881)

NAAC (Cycle-3) 'A' Grade - 3.32 CGPA --College with Potential for Excellence Phase-II

E-Mail: artscollegeuma@gmail.com || Website: uancmahilacollege.org | Mobile: 77789 20502
SINCE 1919 | Youtube: UANC Mahila College, Gandhinagar || Twitter: @UmaandNathiba

Cultural Committee

Prof. Payalben Pandya (Chief Coordinator) (Coordinator – Youth Festival)

Dr. Kirtikamal Vaghela

Prof. Falguniben Patel (Coordinator - Navratri Committee)

Dr. Heenaben Maheta (Coordinator - Days Celebration)

Dr. Jyotiben Panchal

Dr. Ritaben R. Gadhi

Dr. Pranav Joshipura

Prof. Tejas Shah

Dr. Mukeshchandra C. Gor

Dr. Manubhai D. Parmar (Coordinator - Kalshor)

Dr. Naresh D. Dave

Prof. Babubhai N. Chaudhary

Facilities for Cultural Activities:

Auditorium / seminar hall / sports room / library for cultural activities

Costumes

Colours and instruments for rangoli and painting

Stationary for fine arts

Wireless sound system

Podiums

LCD screens

Projectors

Practicing space

Sound system

Musical instruments

DVD player

Pen Drive

Stage Property for theatre activities

Clay for clay modelling

Instruments for Clay modelling

Old Magazines and newspapers for collage

Scrap material for Installation competition

Computer

Expert guidance

Prizes and awards

Exhibition

Knitting and sewing material

Beatification instruments and material



Sports Committee and Facilities 2021-2022

Director of Physical Education: Prof. Hareshbhai M. Patel

Sports Room: Room No - 4

Sports Committee 2021-2022

- | | |
|----------------------------|------------------------|
| 1. Hareshbhai M. Patel | Coordinator |
| 2. Dr. Pranav P. Joshipura | Member |
| 3. Dr. Kiran M. Dave | Member |
| 4. Prof. Arun B. Ganvit | Member |
| 5. Dr. Jyotiben M. Panchal | Member |
| 6. Prof. Bharat P. Kalaria | Member |
| 7. Vaishali Patel | Student Representative |

List of Sports Room Equipment and Facilities

Name of Equipment / Facility	No
Table Tennis Table (T.T. Bat, Ball)	1
Trade Mill	2
Cycle	3
Judo Pit	20
Judo Dress	3
Carom Board	3
Chess Board	4
Electronic Commercial Weight Machine	1
Cricket Kit	1

Boxing Kit	1
Measure Tape	1
VolleyBall net	1
Volley Ball	4
Hand Ball net	1
Hand Ball	4
Stature Meter	1
Multi Gym	1

Indoor Facility of Sports Room

Name of Facility	No
Table for Carom Board and Chess Board	4
Stool for players	12
Iron Cupboard	3
Long size Table	2
Chair	4
Wooden Settee for students	2
Notice Board	1
First Aid Box	1

Sports Room Dimension: 31” feet x 25” feet

Sports Ground Dimension: 58” meter x 54 meter

Prizes distributed to Sports Students for encouragement

Blazer/ track suit is given to the students who are selected at Inter University, Interstate or Open National level team.

Shield or Medal is offered to either the team or individual who wins at Inter College level competition.

In every event of “Ramastav” (Sports Day) of the college shield/medal/certificate is given to the players who win at rank 1 to 3.

T.A./ D.A. as well as Sports Costume is given to every player who participates in Inter-college tournament.

The college also pays the fees and offer T.A. to the players who join in different sports activities run by Sports Authority of India, Gandhinagar.



h.1-2.

NAME OF WORK : RENOVATION OF UMA ARTS & NATHIBA COMMERCE MAHILA COLLEGE AT GANDHINAGAR

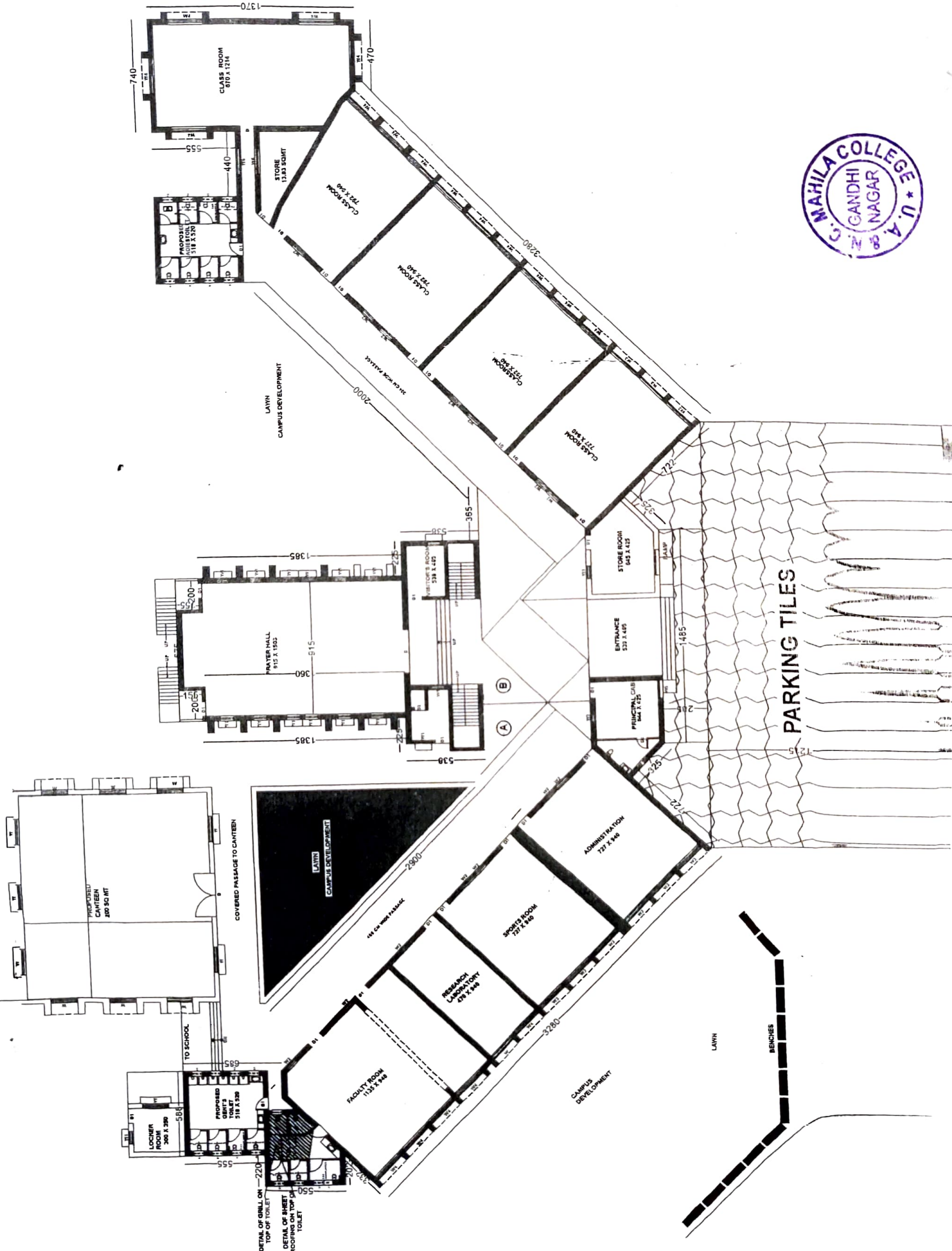

DETAIL OF GRILL ON TOP OF TOILET
 DETAIL OF GRILL ON TOP OF TOILET
 DETAIL OF GRILL ON TOP OF TOILET

BENCHES

PARKING TILES

LAWN
 CAMPUS DEVELOPMENT

LAWN
 CAMPUS DEVELOPMENT

CAMPUS DEVELOPMENT

LAWN
 CAMPUS DEVELOPMENT

COVERED PASSAGE TO CANTINE

TO SCHOOL

TO SCHOOL

TO SCHOOL

TO SCHOOL

TO SCHOOL

TO SCHOOL

TO SCHOOL

TO SCHOOL

TO SCHOOL

TO SCHOOL

TO SCHOOL

TO SCHOOL

LAWN
 CAMPUS DEVELOPMENT

LAWN
 CAMPUS DEVELOPMENT

LAWN
 CAMPUS DEVELOPMENT

LAWN
 CAMPUS DEVELOPMENT

LAWN
 CAMPUS DEVELOPMENT

LAWN
 CAMPUS DEVELOPMENT

LAWN
 CAMPUS DEVELOPMENT

LAWN
 CAMPUS DEVELOPMENT

LAWN
 CAMPUS DEVELOPMENT

LAWN
 CAMPUS DEVELOPMENT

LAWN
 CAMPUS DEVELOPMENT

LAWN
 CAMPUS DEVELOPMENT

LAWN
 CAMPUS DEVELOPMENT

LAWN
 CAMPUS DEVELOPMENT

LAWN
 CAMPUS DEVELOPMENT

LAWN
 CAMPUS DEVELOPMENT

LAWN
 CAMPUS DEVELOPMENT

LAWN
 CAMPUS DEVELOPMENT

LAWN
 CAMPUS DEVELOPMENT

LAWN
 CAMPUS DEVELOPMENT

LAWN
 CAMPUS DEVELOPMENT

LAWN
 CAMPUS DEVELOPMENT

LAWN
 CAMPUS DEVELOPMENT

LAWN
 CAMPUS DEVELOPMENT

LAWN
 CAMPUS DEVELOPMENT

LAWN
 CAMPUS DEVELOPMENT

LAWN
 CAMPUS DEVELOPMENT

LAWN
 CAMPUS DEVELOPMENT

LAWN
 CAMPUS DEVELOPMENT

LAWN
 CAMPUS DEVELOPMENT

LAWN
 CAMPUS DEVELOPMENT

LAWN
 CAMPUS DEVELOPMENT

LAWN
 CAMPUS DEVELOPMENT

LAWN
 CAMPUS DEVELOPMENT

LAWN
 CAMPUS DEVELOPMENT

LAWN
 CAMPUS DEVELOPMENT